

**XILA:**

CARCASS:  
MELAMINE ELM

FINISH:  
BLACK ABYSS SILCOLAK + SIDE PANELS IN GREY STONE

UPPER:  
AMERICAN ELM

HANDLERAIL/TOP:  
BLACK

PLINTH:  
H. 120 BLACK

TOP:  
N.1 GREYSTONE L.1822 DP.830 TH.20 (TMRCPA5)  
N.1 GREYSTONE L.1975 DP.830 TH.20 (TMRCPA5)  
N.1 GREYSTONE L.1892 DP.705 TH.20 (TMRCLA5)

BACK SPLASH:  
N.1 GREYSTONE L.1975 TH.400 (SPBENN02)

SINK:  
N. 1 UNDER-MOUNTED SINK IN GREYSTONE L. 685 X P. 375 (LCONAA104)

N.1 INLAID COUNTERTOP: -3/5 MM. W. 1500 (ZNAB25)

TAP:  
N.1 REAA10

HOOD:  
UPPER HOOD W.1200 (VUPAKI02)

ACCESSORIES DOMESTICI:  
SEE THE DRAWINGS

N.1 UNDERSINK LED LIGHT KIT L.1200 (GMDD07+AVPE001)

ELECTRICAL APPLIANCES BY CLIENT TO BE CONFIRMED:  
N.1 GAGGENAU DISHWASHER MOD. DF480-163 F  
N.2 GAGGENAU HOB VI 242-120 BUILT IN  
N.1 GAGGENAU HOOD MOD. VL 200-120+AR 413-122

APPROVAL SIGNATURE: \_\_\_\_\_



CLIENT: BOFFI STUDIO  
 ADDRESS: STOCCOLMA  
 NUMBER: 155-19  
 REV: 03  
 DESCRIPTION: M30D41-155-19  
 H. CEILING: H.2900-2780 to be confirmed  
 SCALE: 1:20  
 DATE: 07.01.2020  
 ARCHITECT: GIORGIA LICITRA

PLEASE CHECK THAT THE ARCHITECTURAL STRUCTURES, THE DRESSINGS AND THE FURNITURE DRAWN ABOVE ARE CORRECT. UNLESS STATED OTHERWISE IN WRITING THIS PROJECT IS TO BE CONSIDERED THE LATEST VALID VERSION.

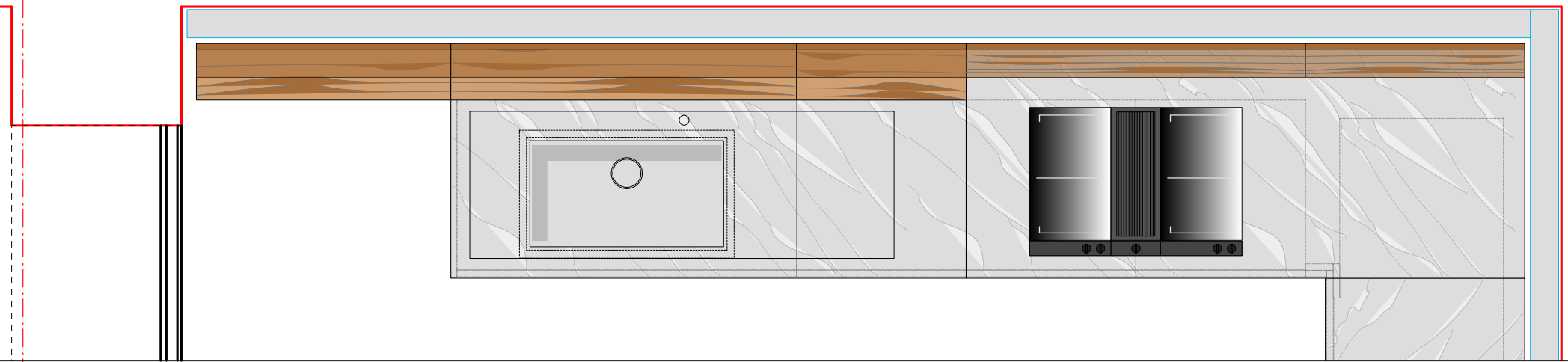

CHECK ON SITE 2900\_DONE

CHECK ON SITE 2750\_DONE

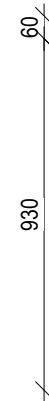
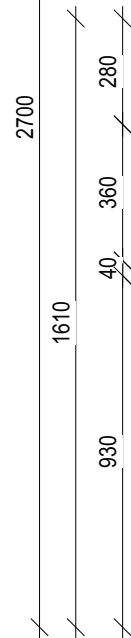

FLY MOON CORNER      SHELVES RH      SHELVES RH

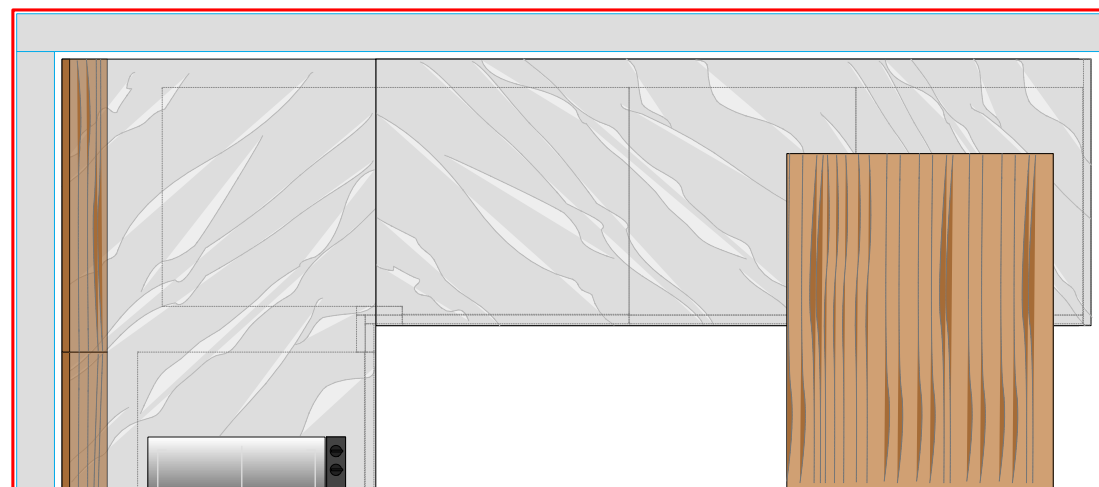
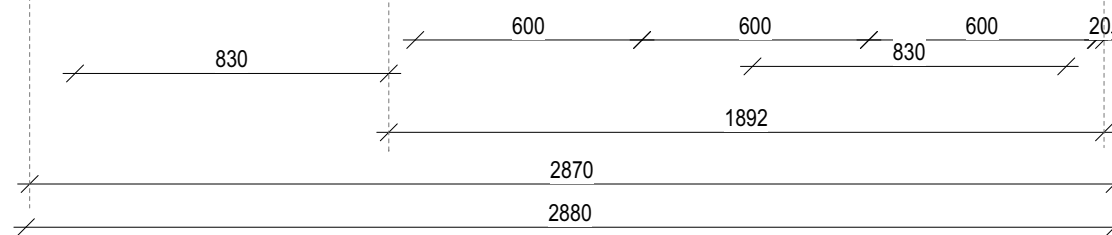

**XILA:**

CARCASS:  
MELAMINE ELM

FINISH :  
BLACK ABYSS SILCOLAK+ SIDE PANELS IN GREY STONE

UPPER:  
AMERICAN ELM

HANDLERAIL/TOP:  
BLACK

PLINTH:  
H. 120 BLACK

APPROVAL SIGNATURE: \_\_\_\_\_

**Boffi**EXPO

CLIENT: BOFFI STUDIO  
 ADDRESS: STOCCOLMA  
 NUMBER: 155-19  
 REV: 03  
 DESCRIPTION: M30D41-155-19  
 H. CEILING: H.2900-2780 to be confirmed  
 SCALE: 1:20  
 DATE: 07.01.2020  
 ARCHITECT: GIORGIA LICITRA

PLEASE CHECK THAT THE ARCHITECTURAL STRUCTURES, THE DRESSINGS AND THE FURNITURE DRAWN ABOVE ARE CORRECT. UNLESS STATED OTHERWISE IN WRITING THIS PROJECT IS TO BE CONSIDERED THE LATEST VALID VERSION.

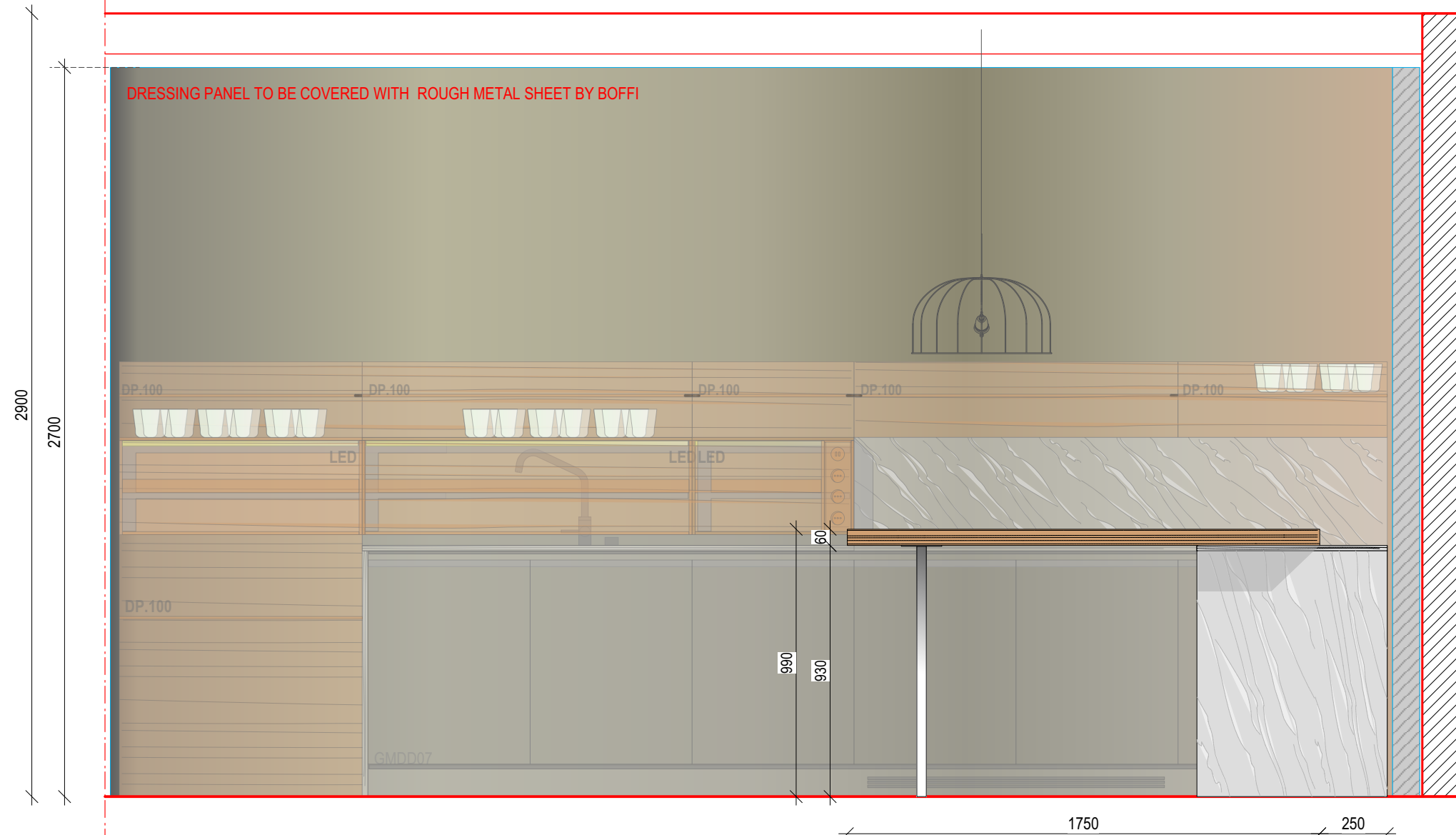

**XILA:**

CARCASS:  
MELAMINE ELM

FINISH :  
BLACK ABYSS SILCOLAK+ SIDE PANELS IN GREY STONE

UPPER:  
AMERICAN ELM

HANDLERAIL/TOP:  
BLACK

PLINTH:  
H.120 BLACK

N.1 AMERICAN ELM PENINSULA W.1750 DP 830 (TTHFPC4)+ LEGS FOR  
PENINSULA SERIE DUEMILAOTTO (GCDB13)

APPROVAL SIGNATURE:

**Boffi**EXPO

CLIENT: BOFFI STUDIO  
 ADDRESS: STOCCOLMA  
 NUMBER: 155-19  
 REV: 03  
 DESCRIPTION: M30D41-155-19  
 H. CEILING: H.2900-2780 to be confirmed  
 SCALE: 1:20  
 DATE: 07.01.2020  
 ARCHITECT: GIORGIA LICITRA

PLEASE CHECK THAT THE ARCHITECTURAL STRUCTURES, THE DRESSINGS AND THE  
 FURNITURE DRAWN ABOVE ARE CORRECT. UNLESS STATED OTHERWISE IN WRITING THIS  
 PROJECT IS TO BE CONSIDERED THE LATEST VALID VERSION.

