

XILA ST

. CARCASS:
WHITE MELAMINE

. FINISH:
WHITE LAMINATE 151(410)+ SIDE PANELS

. TOP:
N.1 SILESTONE WHITE ZEUS W.2430 DP.980 TH.12 (TMQARX2)
N.1 TOP - SNACK USE - OAK HORIZONTAL GRAIN
W.800 DP.980 TH.40 (GDBJ15 + GCDA03 + GCDA04)

. SINK:
N.1 FLUSH-MOUNTED CRS SINGLE BOWL (LBTIAA02
+ ALEL002)

. HANDLE:
HANDRAIL WHITE

. TAP:
N.1 KWC BY BOFFI (REAA4)

. PLINTH:
H.150 WHITE

. HOOD:
N.1 GHOST W.1000 H.500 (VATAKJ02)

. ACCESSORIES:

N.1 DUSTBIN KIT W.900 (ABAA011)

N.1 CUTLERY AND KNIVES TRAY EASY SERIES W.900 (AACV006)
N.1 PLATE RACK EASY SERIES W.900 (AACV014)

. ELECTRICAL APPLIANCES: BOSH BY CLIENT
N.1 DISHWASHER mod. SM59T20EU
N.1 INDUCTION COOKTOP mod. PIB601N24E

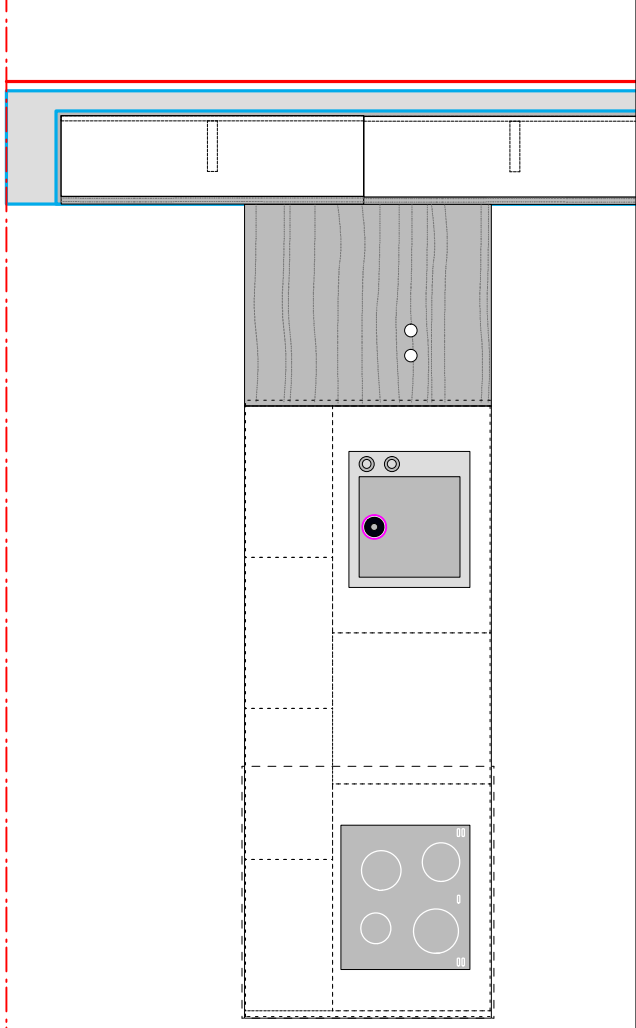
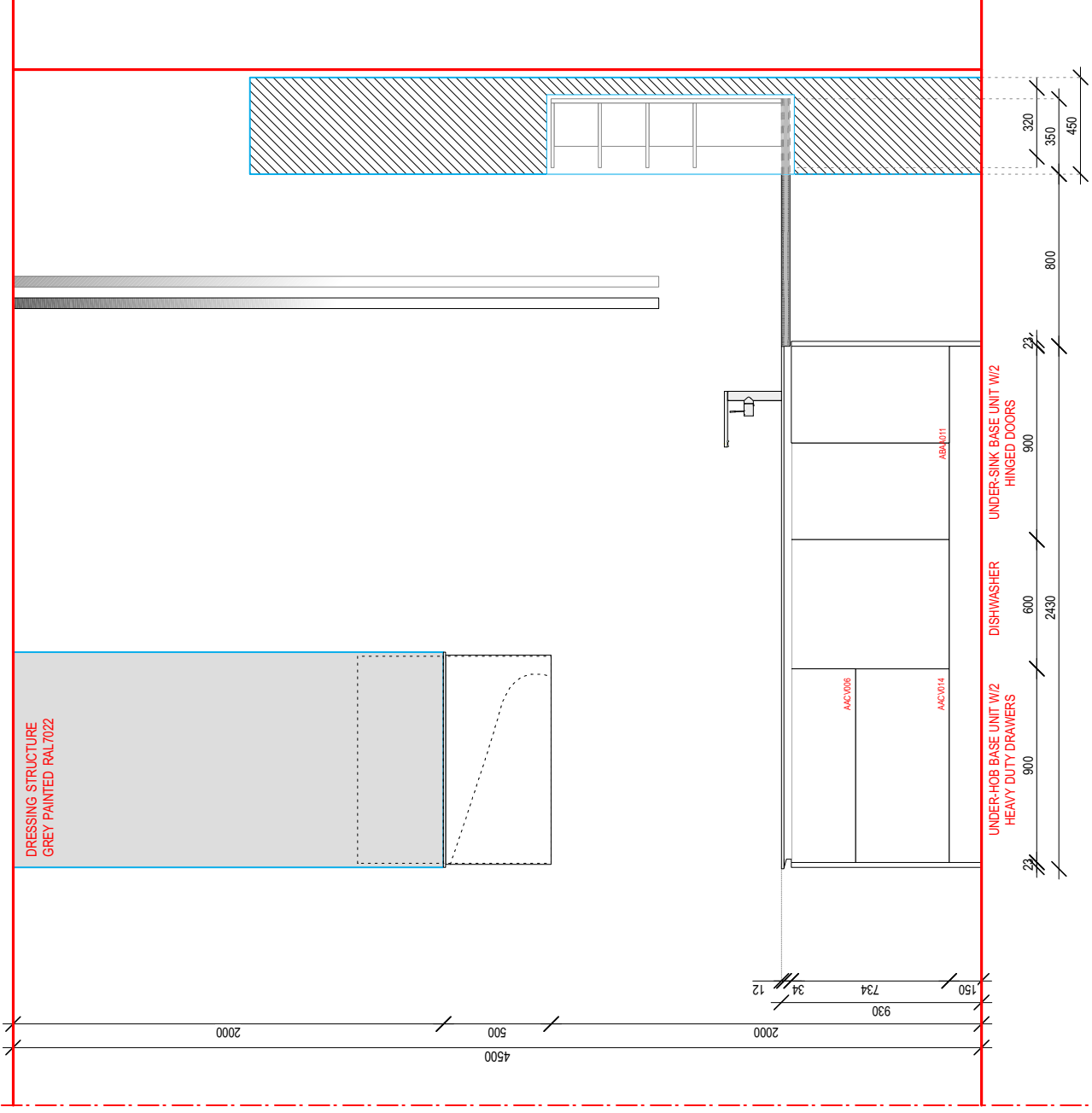

APPROVAL SIGNATURE :

Boffi EXPO

CLIENT: XCELSIORS
ADDRESS: RIGA
NUMBER: 28-12
REV: 03
DESCRIPTION: M30D46-28-12
H. CEILING: 4500
SCALE: 1:30
DATE: 25.09.2012
ARCHITECT: ISABELLA BRIANI

PLEASE CHECK THAT THE ARCHITECTURAL STRUCTURES, THE DRESSINGS AND THE FURNITURE DRAWN ABOVE ARE CORRECT, UNLESS STATED OTHERWISE IN WRITING THIS PROJECT IS TO BE CONSIDERED THE LATEST VALID VERSION.

XILA ST

- . CARCASS:
WHITE MELAMINE
- . FINISH:
WHITE LAMINATE 151 (410)
- . HANDLE:
HANDRAIL WHITE
- . PLINTH:
H.150 WHITE
- . TOP:
N.1 OAK HORIZONTAL GRAIN W.2400 DP.350 TH.40 (GDBJ15 + GCGA05)
N.2 FINISHED SHELVING SYSTEM - TERMINALE USE W.1200 H.1070 DP.320 IN OAK HORIZONTAL GRAIN (PESEB12ST)

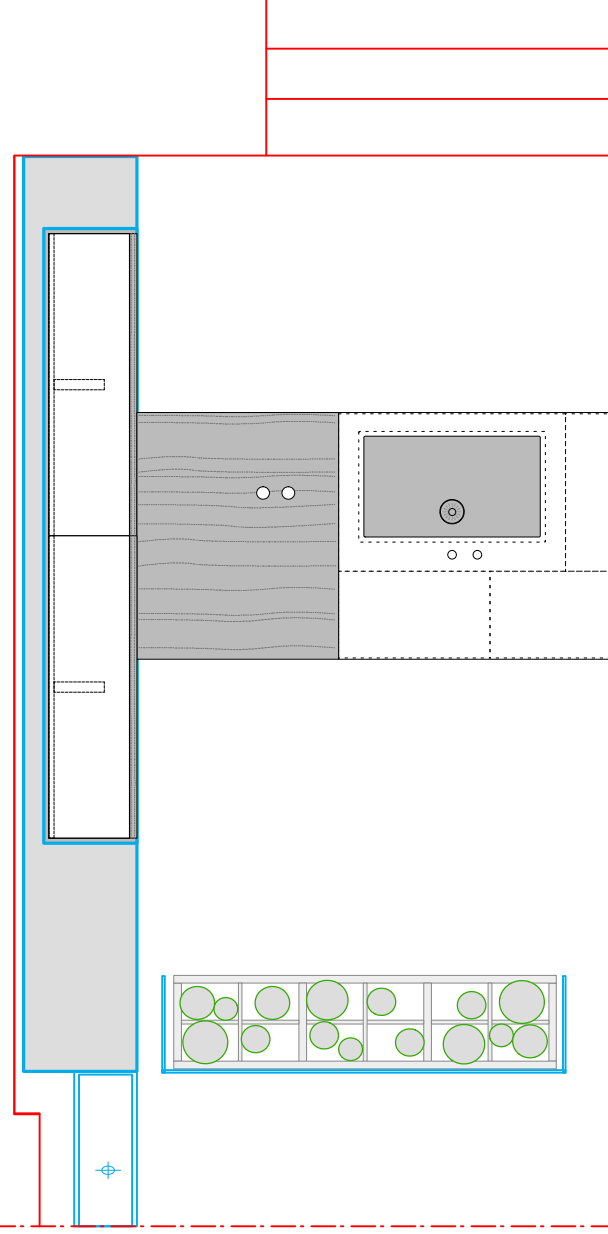
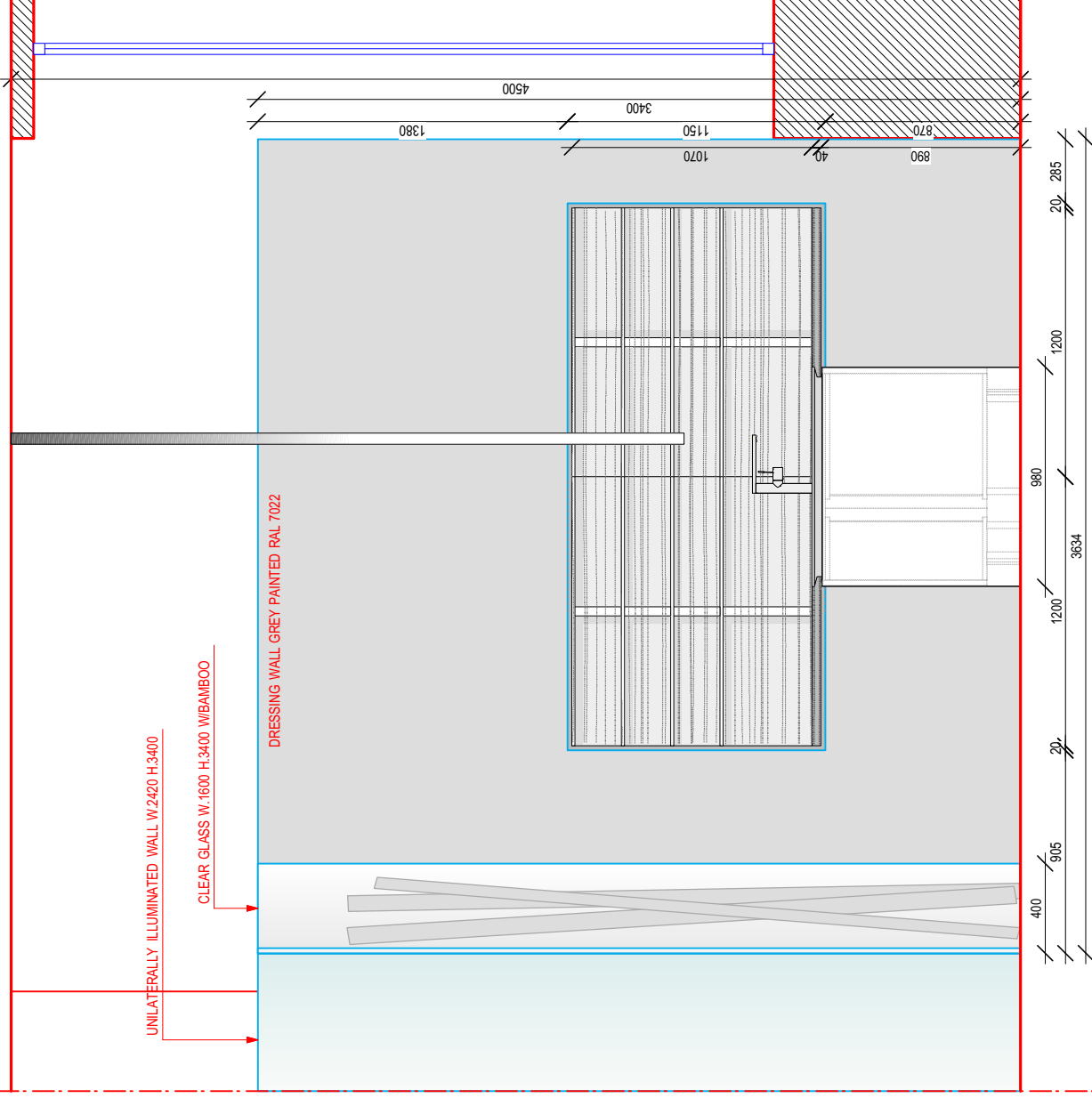

APPROVAL SIGNATURE :

Boffi EXPO

CLIENT: XCELSIORS
ADDRESS: RIGA
NUMBER: 28-12
REV: 03
DESCRIPTION: M30D46-28-12
H. CEILING: 4500
SCALE: 1:30
DATE: 25.09.2012
ARCHITECT: ISABELLA BRIANI

PLEASE CHECK THAT THE ARCHITECTURAL STRUCTURES, THE DRESSINGS AND THE FURNITURE DRAWN ABOVE ARE CORRECT, UNLESS STATED OTHERWISE IN WRITING THIS PROJECT IS TO BE CONSIDERED THE LATEST VALID VERSION.