

**XILA\_EXISTING**

. CARCASS:  
MELAMINE GRAPHITE GREY OAK

. FINISH:  
LASERMAT WHITE MALE' / SIDE PANELS D.653

. HANDLE:  
WHITE HANDRAIL

. PLINTH:  
H.80 WHITE

. PREMIERE WHITE SERIES ACCESSORIES :  
N.1 CUTLERY TRAY W.600 (AADK015 + AADK009)  
N.1 CUTLERY TRAY W.600 (AADJ026)  
N.1 CUTLERY TRAY W.600 (AADK015 + AADK006)  
N.1 PLATES RACK W.600 (AADJ032)  
N.1 PLATES RACK W.600 (AADJ031)

. APPLIANCES MIELE BY CLIENT  
*PLEASE ADVISE IF AVAILABLE FOR LITHUANIAN MARKET:*  
N. 1 OVEN MOD. H 6461 B INOX (EFMACEB40)  
N. 1 STEAM OVEN MOD. DG 6401 INOX (EFMAMEB09)  
N. 1 WARMING DRAWERS MOD. ESW 6114 INOX (EFMAAEB02)  
N.1 REFRIGERATOR + FREEZER MOD. KF 1801 VI - RH (EAMBCI002)  
N.1 WINE COOLER MOD. KWT 1612 VI - LH (EAMCQE004)

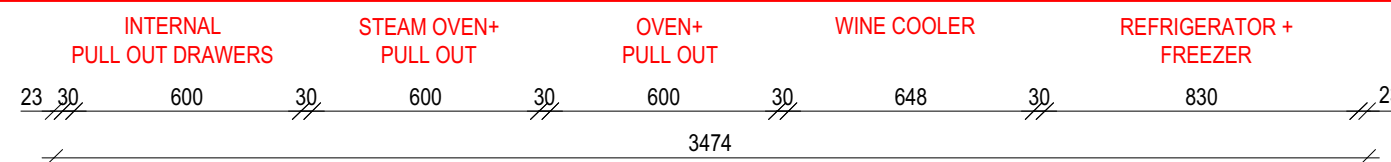
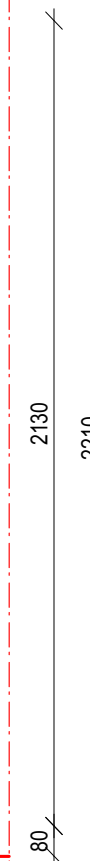
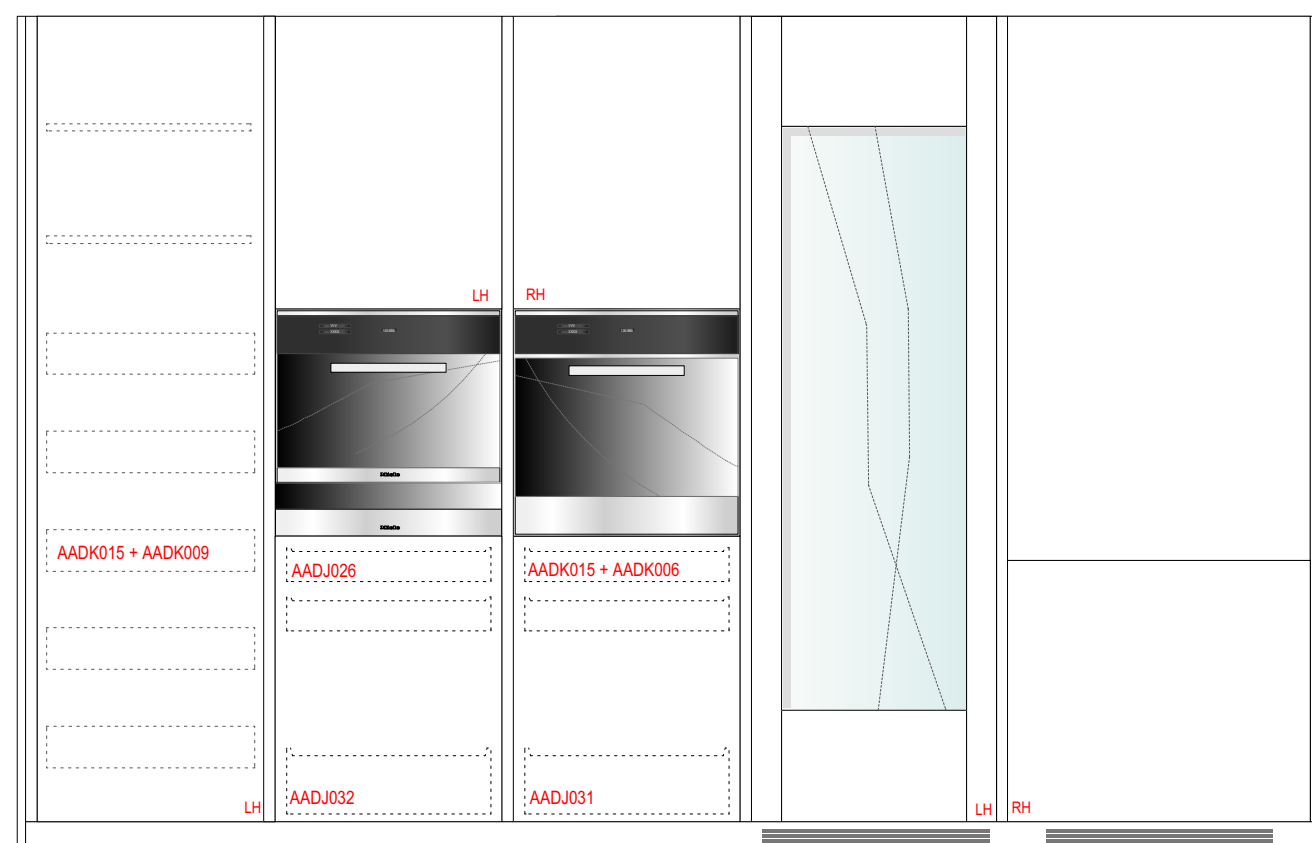

APPROVAL SIGNATURE :



CLIENT: XCELSIOR  
ADDRESS: VILNIUS  
NUMBER: 92-18  
REV: 02  
DESCRIPTION: M30D41COL-92-18  
H. CEILING: 5000  
SCALE: 1:20  
DATE: 27.03.2018  
ARCHITECT: DOMENICO SORRENTINO

PLEASE CHECK THAT THE ARCHITECTURAL STRUCTURES, THE DRESSINGS AND THE FURNITURE DRAWN ABOVE ARE CORRECT. UNLESS STATED OTHERWISE IN WRITING THIS PROJECT IS TO BE CONSIDERED THE LATEST VALID VERSION.