

SALINAS

. CARCASS:
TUBULAR METAL STRUCTURE DARK GREY PAINTED
BOTTOM/INTERNAL FINISHES PANELS IN METAL SHEET

. FINISHES:
DOORS FRAME IN EXTRUDE ALUMINUM PROFILE BLACK ANODISED
FRONT PANELS FINISHED (SEE DESCRIPTIONS ON DRAWINGS)

. PIANO:
DECORATED GREY LAVA STONE
N. 1 SLIDING PENINSULA IN OLIVATO ASH WOOD

. SINK:
ABSOLUTE ZIMBAWE BLACK GRANITE

. TAP:
N. 1 REAA10 BLACK
N. 1 RJFA04 BLACK
N. 1 ALER01N BLACK

. ACCESSORIES DOMESTICI MOVE:
N. 2xAADQ013
N. 2xAADQ018
N. 1 AACY052
N. 1 AADC017
N. 1 AACY053
N. 1 AACY064
N. 1 AACY095
N. 1 AADC007

N. 1 TERRACOTTA VASE 470X167 H.180
N. 6 BOXES 280X300 H.150 IN ASH WOOD

. HOOD:
DOWN DRAFT

. GAGGENAU ELECTRICAL APPLIANECES BY CLIENT:
N.1 HOB UNIT W/2 GAS MOD. VG 232
N.1 WOK MOD. VG 231
N.1 INDUCTION MOD. VI 230
N.1 DISHWASHER MOD. DF 461 164 - H. 865 MM

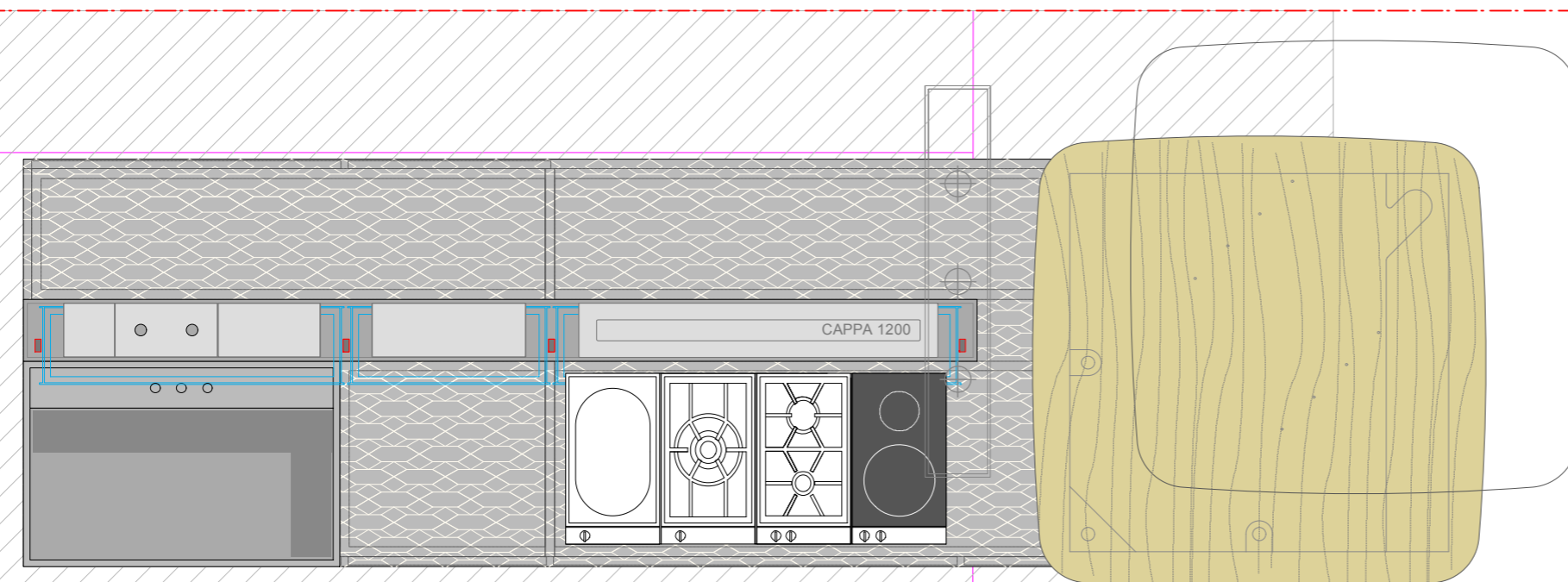
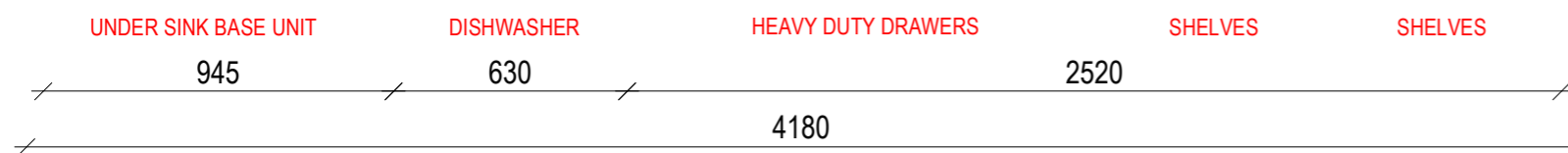
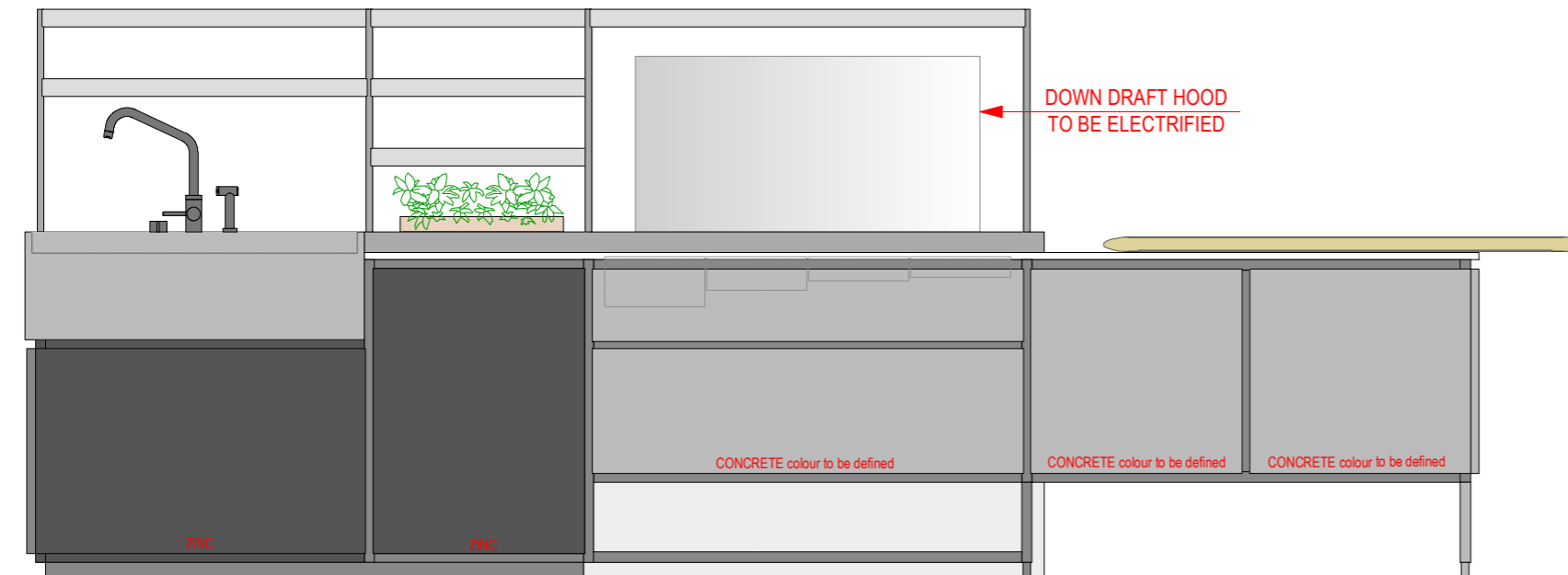

APPROVAL SIGNATURE :

BoffiEXPO

CLIENT: BOFFI STUDIO
ADDRESS: SYDNEY
NUMBER: 74-15
REV: 02
DESCRIPTION: M30D56-74-15
H. CEILING: 2953-3092- SPRINKLER 2840
SCALE: 1:20
DATE: 19.05.2015
ARCHITECT: SIMONA MASELLI

PLEASE CHECK THAT THE ARCHITECTURAL STRUCTURES, THE DRESSINGS AND THE FURNITURE DRAWN ABOVE ARE CORRECT. UNLESS STATED OTHERWISE IN WRITING THIS PROJECT IS TO BE CONSIDERED THE LATEST VALID VERSION.

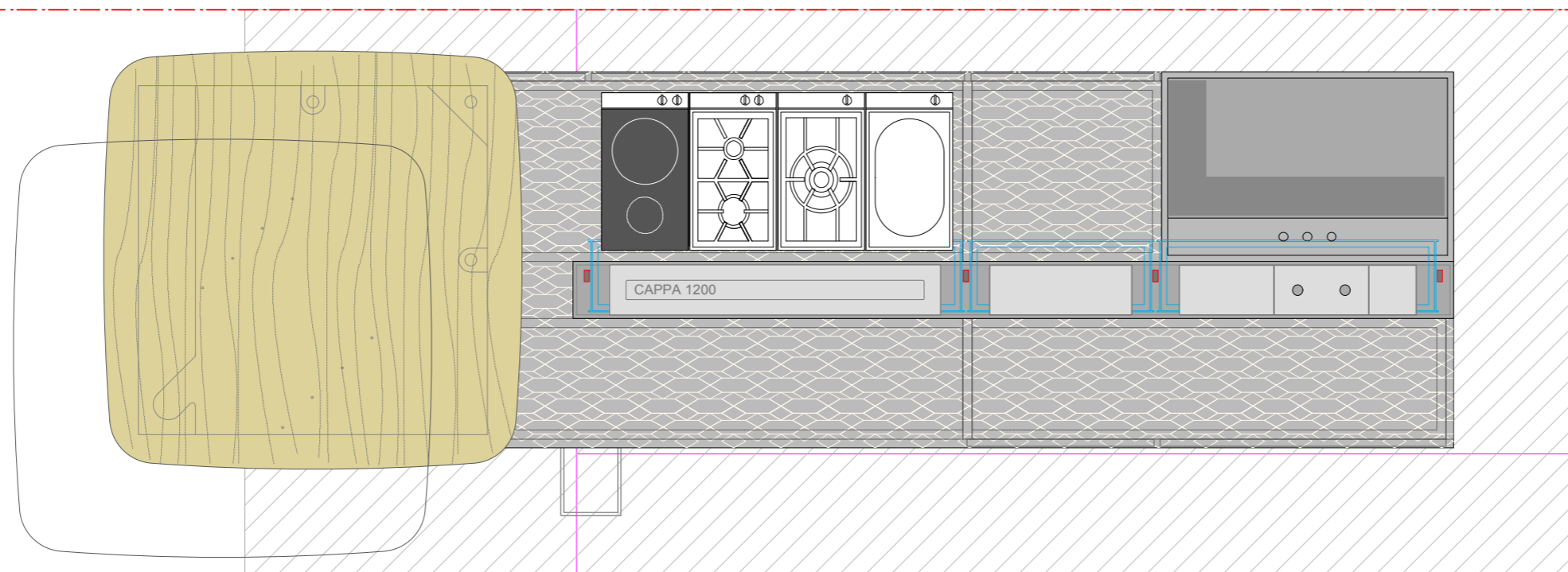
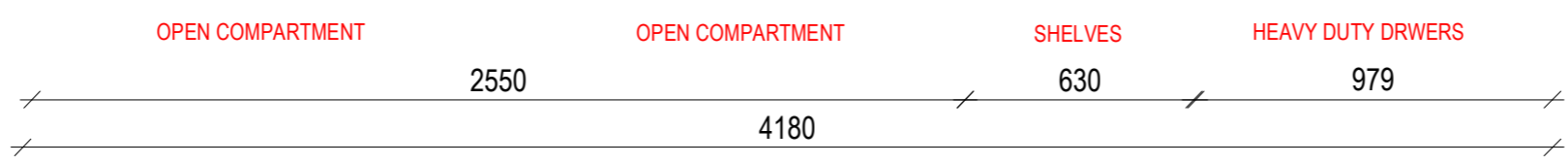
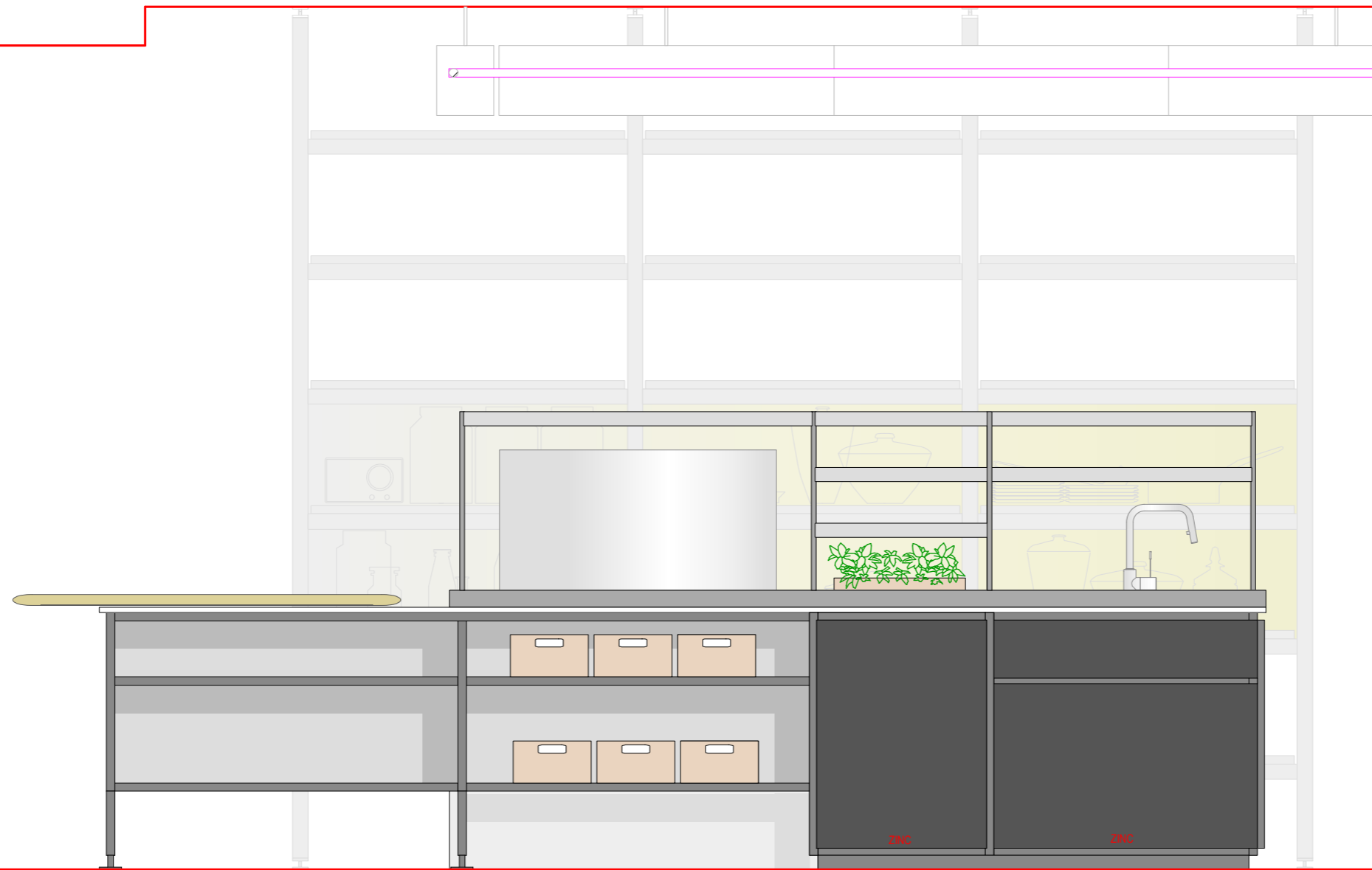

APPROVAL SIGNATURE :

BoffiEXPO

CLIENT: BOFFI STUDIO
 ADDRESS: SYDNEY
 NUMBER: 74-15
 REV: 02
 DESCRIPTION: M30D56-74-15
 H. CEILING: 2953-3092- SPRINKLER 2840
 SCALE: 1:20
 DATE: 19.05.2015
 ARCHITECT: SIMONA MASELLI

PLEASE CHECK THAT THE ARCHITECTURAL STRUCTURES, THE DRESSINGS AND THE FURNITURE DRAWN ABOVE ARE CORRECT. UNLESS STATED OTHERWISE IN WRITING THIS PROJECT IS TO BE CONSIDERED THE LATEST VALID VERSION.