

**PROGRAMMA STANDARD TALL UNITS**

CARCASS:  
MELAMINE GRAPHITE GREY OAK

FINISH:  
BLACK POLYESTER

HANDLE:  
X36 (pos. DV\_handles to be placed as handle wine cellar at 40mm from edge )

PLINTH:  
H.80 BLACK

EASY ACCESSORIES :  
N.1 CUTLERY TRAY L.900 (AACV086)

ELECTRICAL APPLIANCE **BY CLIENT**:  
N.1 SUBZERO FREEZER MOD. ICBIK-24FI (LH)  
N.1 SUBZERO REFRIGERATOR MOD. ICBIK-24R (RH)  
N.1 SUBZERO WINE CELLAR ICBIW24(RH)  
N.1 GAGGENAU OVEN MOD. BO 480  
N.1 GAGGENAU COMBI STEAM OVEN BS 484  
N.1 GAGGENAU WARMING DRAWER WS 482

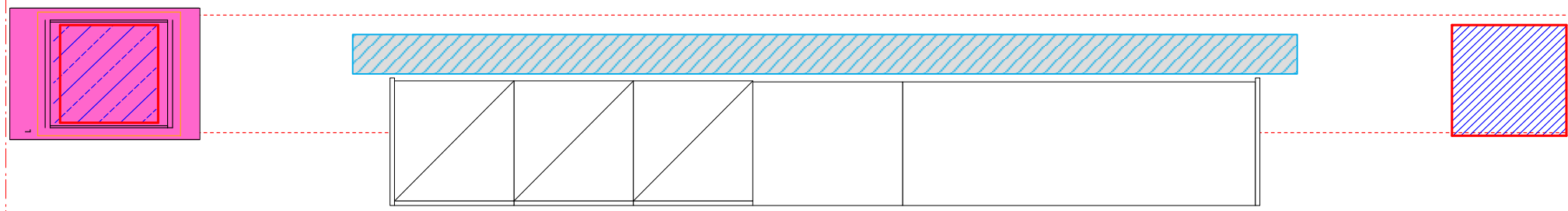
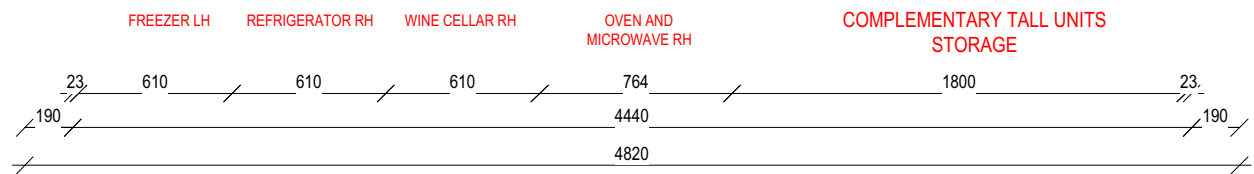
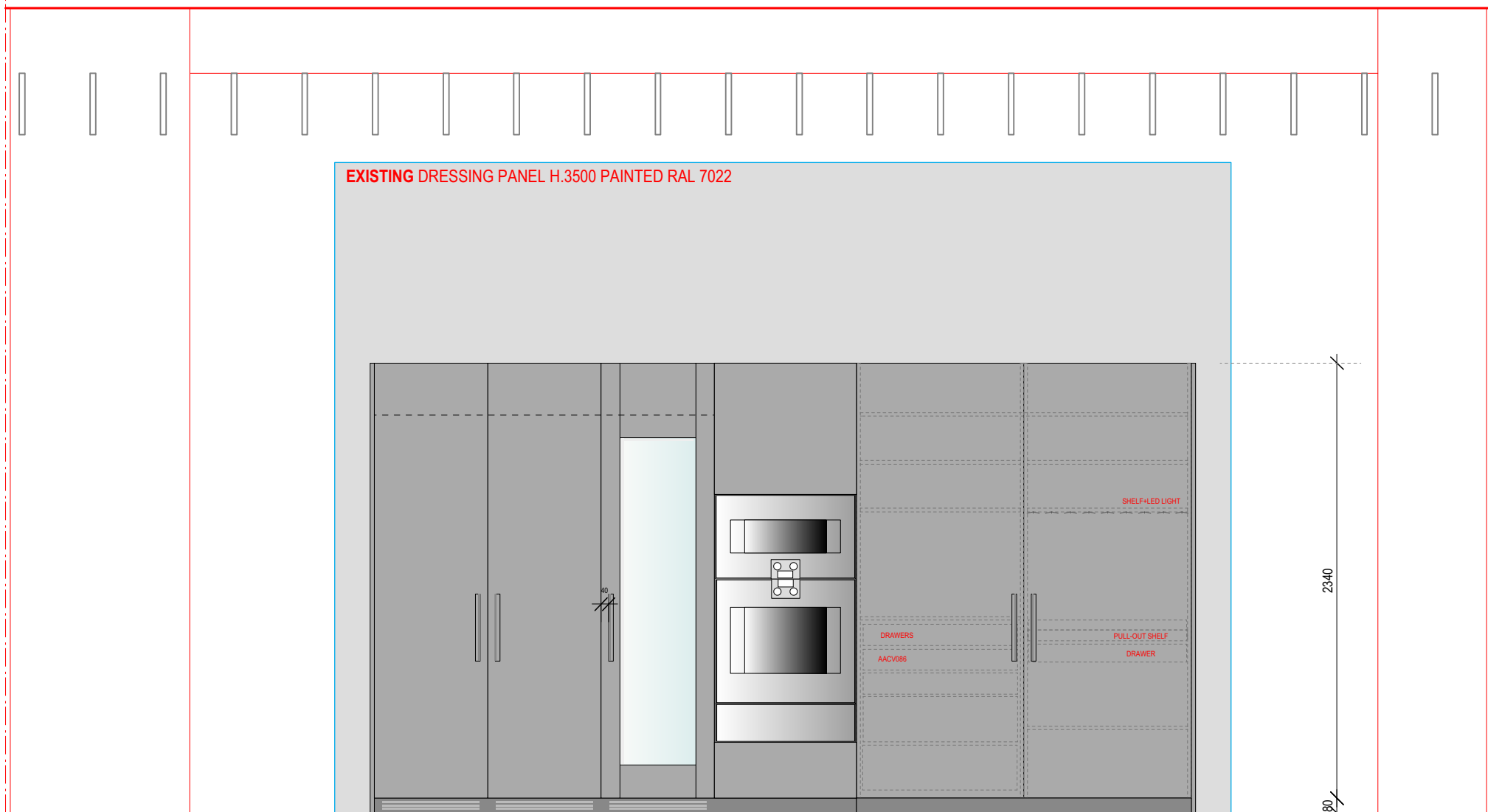

APPROVAL SIGNATURE :



CLIENT: BOFFI  
ADDRESS: FRANKFURT  
NUMBER: 126-16  
REV: 02  
DESCRIPTION: M30D3COL-126-16  
H. CEILING: CONTROSOFFITTO LAMELLE H.3650;SOFFITTO H.4330;H.SOTTOTRAVE 3980  
SCALE: 1:30  
DATE: 15.09.2016  
ARCHITECT: GIORGIA LICITRA

PLEASE CHECK THAT THE ARCHITECTURAL STRUCTURES, THE DRESSINGS AND THE FURNITURE DRAWN ABOVE ARE CORRECT. UNLESS STATED OTHERWISE IN WRITING THIS PROJECT IS TO BE CONSIDERED THE LATEST VALID VERSION.